

ETCR1000 Series Phase Detector

- Radical Technological Change, Non-Contact Detection
- Phase Detection, Live Wire Examination, Power Inspection, Phase Deficiency Judgment, Breakpoints Finding
- Breakpoints Finding and Line Maintenance on DC Circuit
- Safe and Quick Detection, Greatly increase productivity
- LED Dynamic Display, Intuitive and Clear



Brief Introduction

Traditional phase sequence measurement methods must poke the three-phase wire terminal, and connect the three bare alligator clips or test pins of phase sequence meters to the three bare fire wires, while ETCR1000A uses clamp non-contact measurement, without taking off the wire and there is no need to contact high-voltage bare fire-wire, the test can be made through directly clamping the three-phase insulating sheath by three super-sensitive high-insulated clamps; conducting measurement on sheathed cable significantly improves the safety of field testing, effectively protect the operator's personal safety and increase productivity!

In addition to phase sequence detection, it also has the functions of live wire examination, simple power detection, fire-wire identification, phase deficiency determination, break location detection, DC line break and line maintenance, equivalent to 3 induction electric pens. LED dynamic display, very intuitive and clear. It is a essential tester in Power Phase Detection, Motor Phase Detection and Line Maintenance.

The ETCR1000A Clamp sensor is sensitive enough to sense the AC voltage signal as low as a few Volts, with a wider range of live electricity. The three clamps of ETCR1000A are in three colors, Red, Yellow and Blue; It is more in line with the distinction of three-phase line, and more scientific and artistic overall appearance. ETCR1000A has a better power-saving performance with the Maximum Rated Power of 100mVA.

Field Application

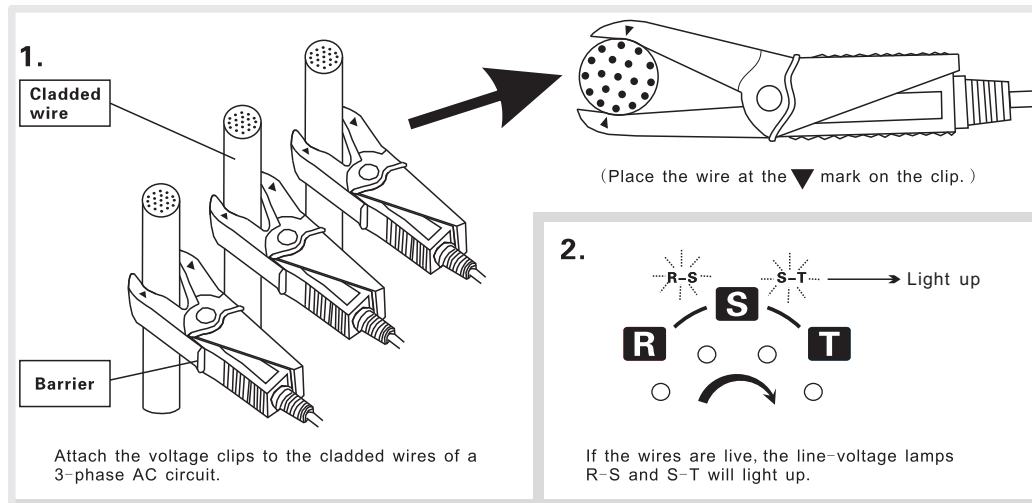

Technical Specifications

Model	ETCR1000A
Function	Phase detection (Normal, Reverse), Live wire examination, Simple power inspection, Phase deficiency judgment, Breakpoints finding and Line maintenance
Display Mode	LED
Power Supply	DC3V AA Mn batteries (R6P)×2 PCS
Live Voltage Range	AC70V~600V, 40Hz~70Hz(Sine Wave Continuous Input)
Clamp Wire Size	Diameter ϕ 18mm
Auto Power off	3 minutes after booting up, the meter automatically cut off power supply.
Meter Dimension	L×W×H: 70mm×75mm×30mm
Clamp Lead Length	0.5m
Meter Weight	180g(with batteries)
Working Temperature and Humidity	-10℃~55℃; below 80%rh
Maximum Measured Voltage	AC600V
Dielectric Strength	5.4kV/rms
Maximum Rated Power	100mVA
Accessories	Meter: 1 PC; Carrying case: 1 PC.